



ERGONOMICA



Características Técnicas
Technical Data

Cuerpo Compacto, Resistente a Impactos, con Aislamiento Térmico y Eléctrico
Compact body, impact resistance, electric and thermal insulation
Puño Ergonomico
Ergonomic handle
Leve/Compacto
Light/compacta



Indicaciones
Recommendation

Chapa (Carrocería)
Vehicle bodyworks
Artesanías
Artesan work
Trabajos leves en general para acero carbono, aluminio e acero inoxidable
Light works with steel, aluminium and stainless



Peso Aparente (Kg)
Seaming Weight (Kg)

0,800



Peso Líquido (Kg)
Net Weight(Kg)

3,000 (Torcha c/ Cable 3,00m)

| Ciclo de Trabajo - Duty Cycle | |
|-------------------------------|-----------------------------------|
| 180A / 60% | 160A / 60% |
| CO ₂ | Argônio e Misturas Argon Mixed |
| 0,6 a 1,0 | |
| Arames (mm) Wires (mm) | |

OJV 220

| Código/Code | Descripción/Description | Med./Mes. |
|-------------|--|-----------|
| 220.003.001 | Torcha MIG/MAG OJV 220 Euro Conector OJV 220 MIG/MAG Welding Torch w/Euro Connector | 2,00m |
| 220.003.002 | | 3,00m |
| 220.003.003 | | 4,50m |

Torcha/Torch MIG MAG OJV 220

| Foto/Photo | Pos. | Código/Code | Descripción/Description | Med./Mes. |
|------------|-------------|---|--|-----------|
| | 13 | 220.001.020 | Guía Espiral Gris 0,60/0,80mm Gray Steel liner 0,60/0,80mm | 2,00m |
| | | 220.001.021 | | 3,00m |
| | 220.001.022 | Guía Espiral Verde 0,60/0,80mm Green Steel liner 0,60/0,80mm | 4,50m | |
| | 13 | 220.001.023 | | 2,00m |
| | | 220.001.024 | Guía Espiral Verde 0,80/1,00mm Green Steel liner 0,80/1,00mm | 3,00m |
| | | 220.001.025 | | 4,50m |
| | 14 | 220.001.026 | Tuerca Fijadora del Resorte Euro Conector Euro Connector Spring Nut | |
| | 15 | 220.001.027 | Soporte del Euro Conector Euro Connector Support | |
| | 16 | 220.001.028 | Tomillo Fijador del Euro Conector Euro Connector Screw | |

Componentes/Components

Torcha/Torch MIG MAG OJV 220

| Foto/Photo | Pos. | Código/Code | Descripción/Description |
|------------|------|-------------|---|
| | 17 | 220.001.029 | Tuerca del Euro Conector Euro Connector Nut |
| | 18 | 220.001.030 | Tuerca de Encastre Nut |
| | 19 | 220.001.332 | Anillo de la Guía Espiral Gris 0,60/0,80mm Gray Steel Liner O-Ring |
| | | 220.001.031 | Anillo de la Guía Espiral Verde 0,80/1,00mm Green Steel Liner O-Ring |
| | 20 | 220.002.727 | Euro Conector Macho Male Connector |
| | 21 | 220.002.603 | Tuerca Fija de la Guía Espiral Steel Liner Nut |
| | 22 | 220.001.034 | Anillo de Gas Gas O-Ring |
| | 23 | 220.501.661 | Cuerpo Flexible de la Torcha Flexible Torch Body |
| | 24 | 220.015.170 | Conjunto Contacto Retractivo Macho Lado de la Torcha Spring Pin |
| | 24 | 220.004.010 | Capa Protectora del Cable (Opcional) Cable Protection Cover (Optional) |
| | 25 | 220.021.607 | Aislante del Cuerpo Insulator Body |

Componentes/Components

Torcha/Torch MIG MAG OJV 220



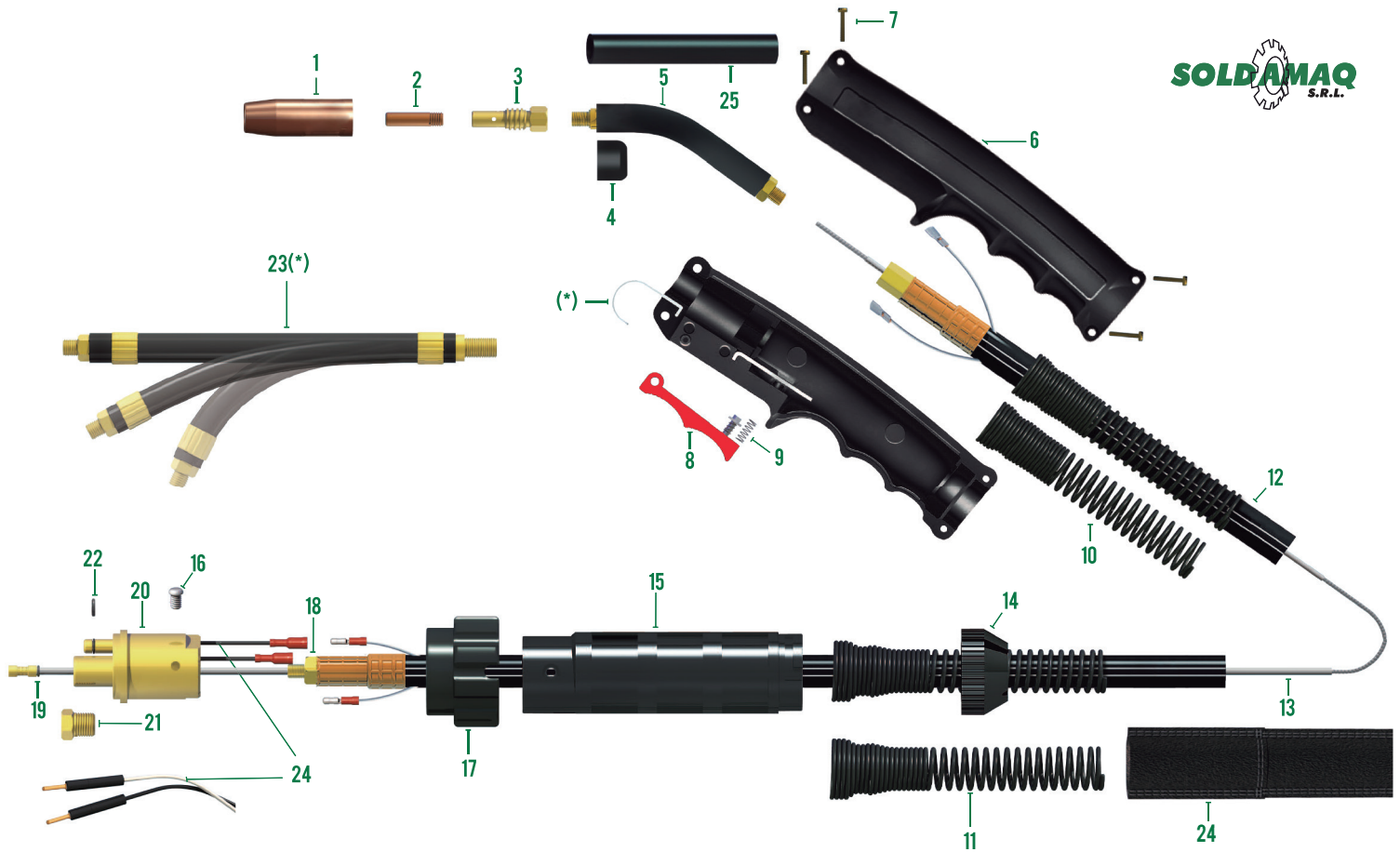

(*) Línea de Opcionales/Optional Line

| Foto/Photo | Pos. | Código/Code | Descripción/Description | Med./Mes. |
|---|------|-------------|---|-----------|
| | 1 | 220.002.667 | Punt. Única con Rosca Nozzle w/Spiral | ø9x55mm |
| | | 220.002.668 | | ø12x55mm |
| | 2 | 220.001.004 | | 0,60mm |
| | | 220.001.005 | Tubo de Contacto M6 E-Cu E-Cu M6 Contact Tip | 0,80mm |
| | | 220.001.188 | | 0,90mm |
| | | 220.001.006 | | 1,00mm |
| | 3 | 220.001.007 | Difusor de Gas Gas Diffuser | |
| | 4 | 220.001.008 | Aislador del Difusor de Gas Gas Diffuser Insulator | |
| | 5 | 220.001.010 | Cuerpo de la Torcha Torch Body | |
| Componentes/Components Torcha/Torch MIG MAG UV 220 | | | | |

| Foto/Photo | Pos. | Código/Code | Descripción/Description | |
|---|------|-------------|--|-------|
| | 6 | 220.021.546 | Puño de la Torcha Torch Handle | |
| | 7 | 220.001.012 | Tomillo del Puño Handle Screw | |
| | 8 | 220.021.427 | Accionamiento Corto de la Torcha Short Torch Trigger | |
| | 9 | 220.001.014 | Resorte del Accionamiento Corto Short Trigger Spring | |
| | 10 | 220.001.015 | Resorte Delantero del Cable Front Cable Protection Spring | |
| | 11 | 220.001.016 | Resorte Trasero del Cable Rear Cable Protection Spring | |
| | 12 | 220.001.017 | | 2,00m |
| | | 220.001.018 | Cable de Corriente 25mm ² Current Cable | 3,00m |
| | | 220.001.019 | | 4,50m |
| Componentes/Components Torcha/Torch MIG MAG UV 220 | | | | |